

# BLEFARI MOUNT BARKER

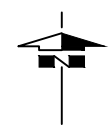

## Stage 2 Building Envelope Plan

Scale 1:2500

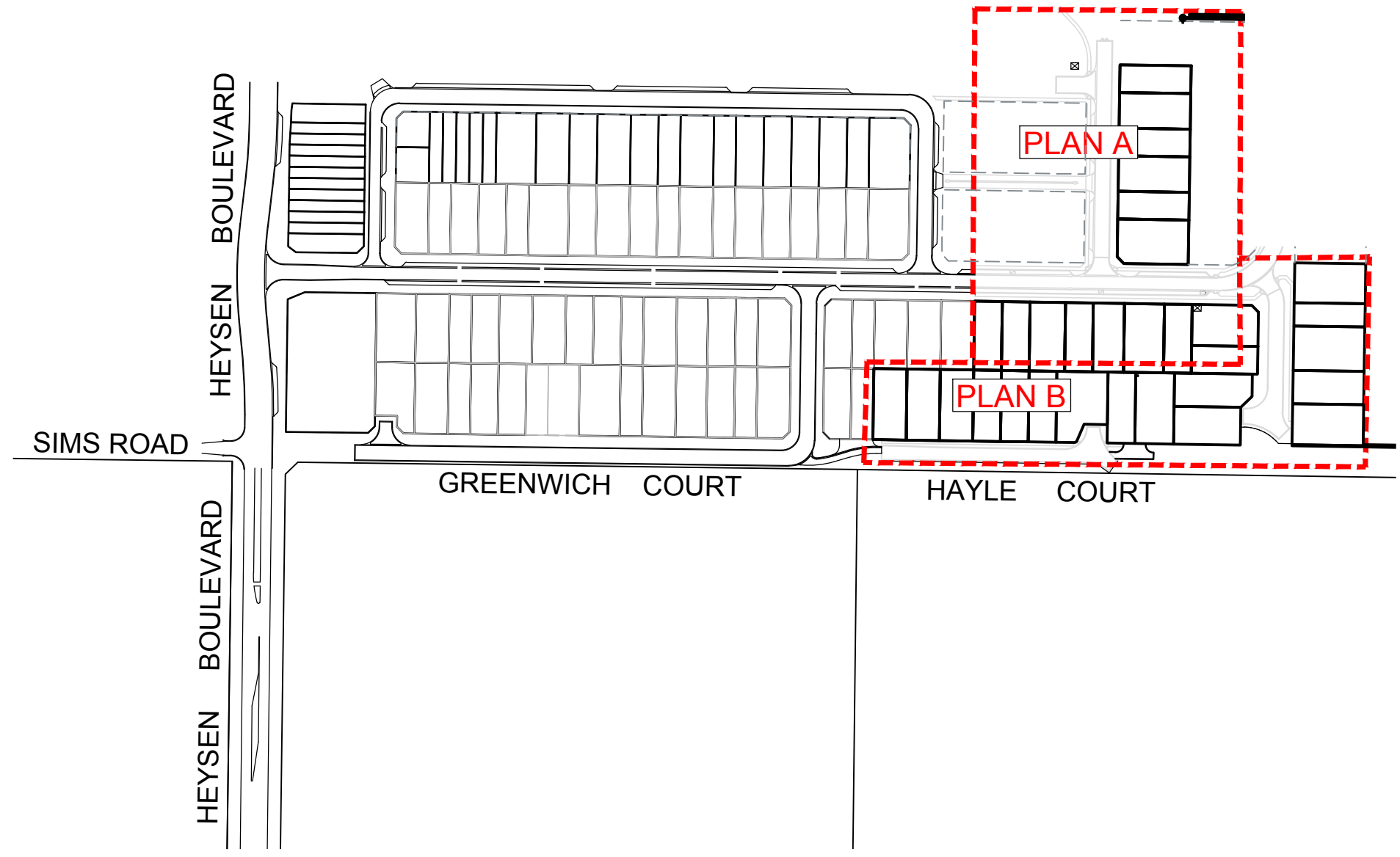

### Key Plan

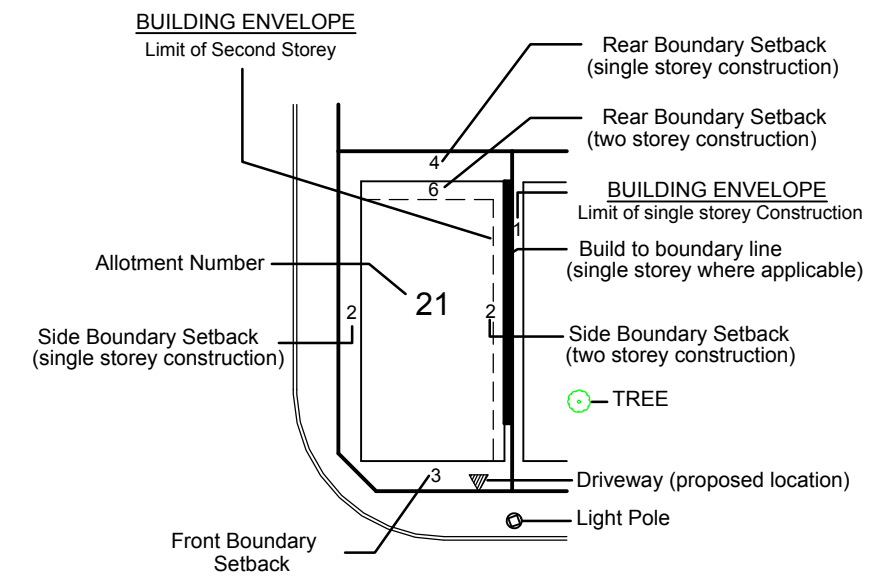

REVISION	DATE
5 EASEMENT IN 2039 REMOVED	26/09/18
4 UPDATE ROAD NAMES	29/06/18
3 UPDATE LOT 2036	09/02/18
2 UPDATE ROAD NAMES	17/01/18
1 AMEND ALLOT 2041 & REMOVE	11/01/18
0 ISSUED TO CLIENT	14/12/17

<b>FYFE Earth Partners</b>	
ACN 008 116 130	
LEVEL 3, 80 FLINDERS STREET, ADELAIDE, SA, 5000	
GPO BOX 2450 ADELAIDE SA 5001	
TEL (08) 8201 9600	FAX (08) 8201 9650
E-mail info @ fyle.com.au	
REVISION : 5	DRAWING : 21003B17-R5
FILE No : 21003/21/4	DATE OF ISSUE : 26/09/2018
DRAWN : KAJ	CHECKED : JJB

**NOTE:**  
SUBJECT TO CONFIRMATION OF EASEMENTS.  
Road layout and associated infrastructure is indicative only.  
Road naming to be confirmed and subject to council approval.  
Building on the boundary subject to council consent.

NB: The 'Building Envelope Plan' must be read in conjunction with the written guidelines

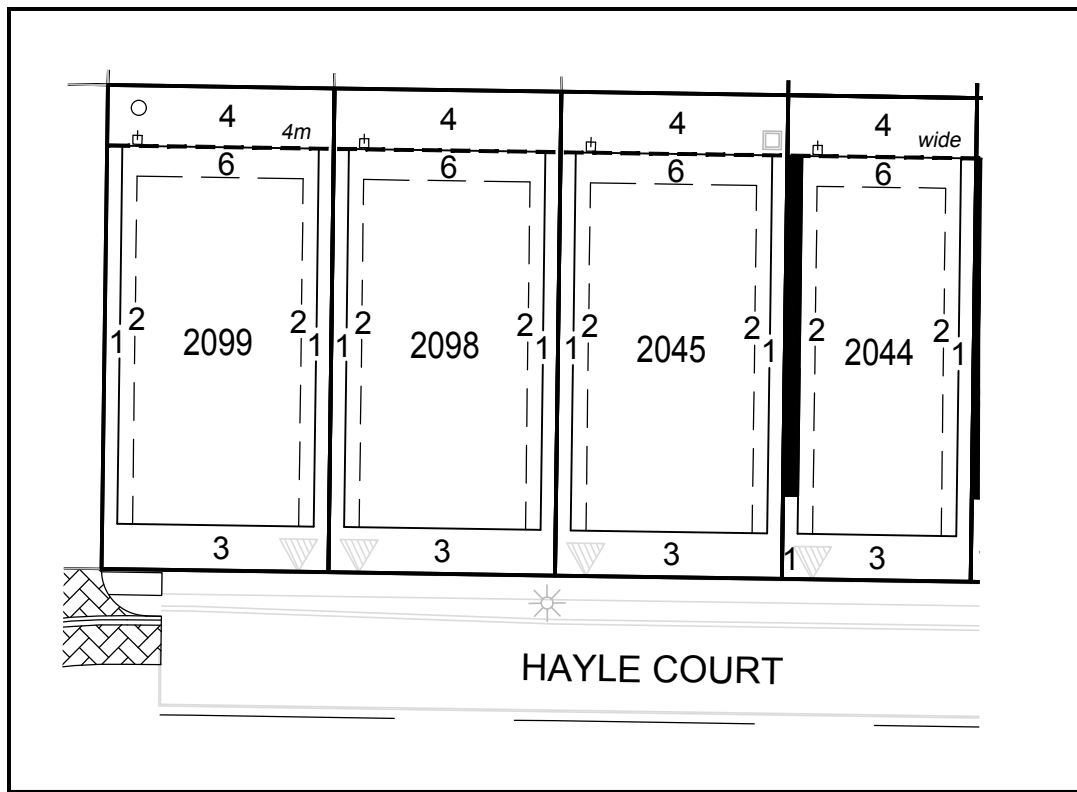

Vide Below Left

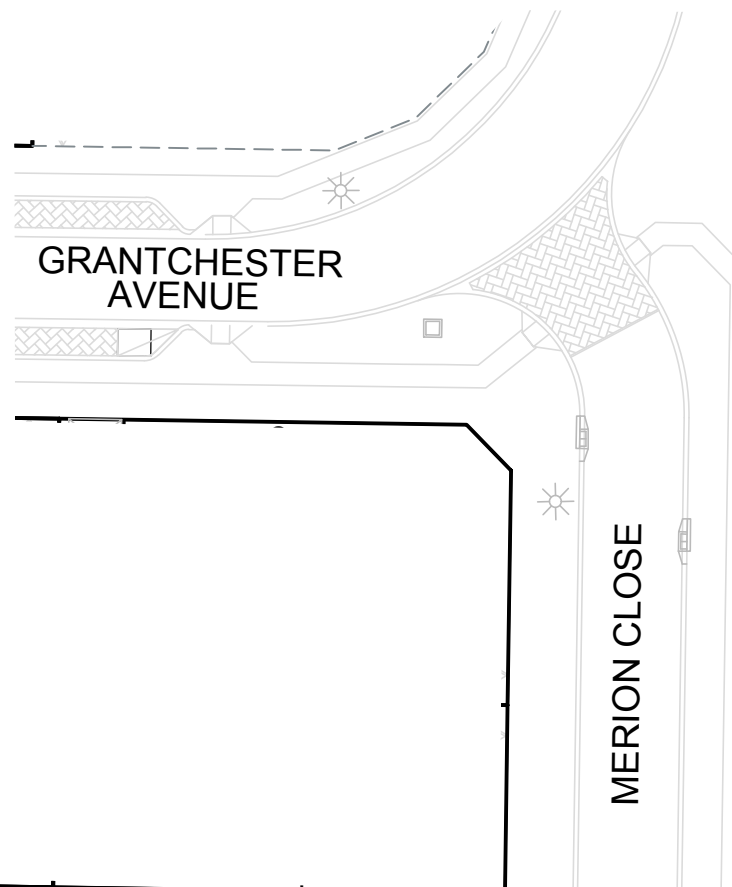

Future Stage

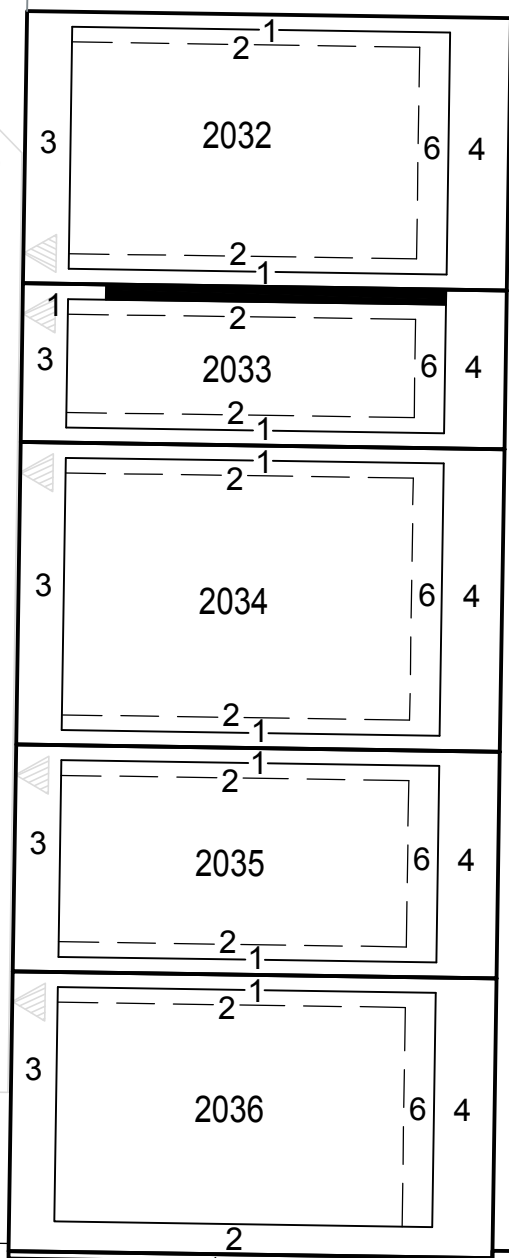

Buffer Reserve

Vide Above for Continuation

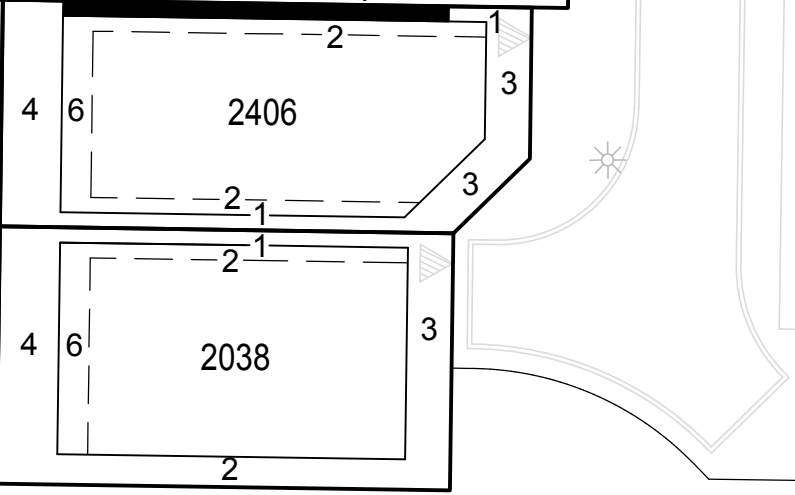
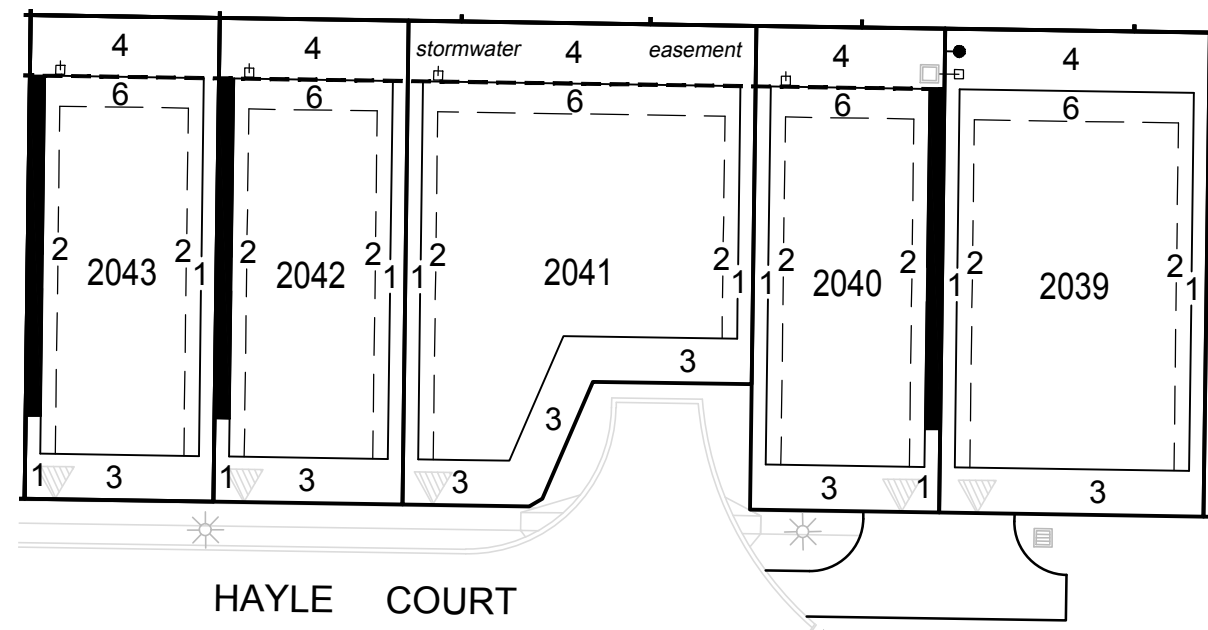

REVISION	DATE	
5	EASEMENT IN 2039 REMOVED	26/09/18
4	UPDATE ROAD NAMES	29/06/18
3	UPDATE LOT 2036	09/02/18
2	UPDATE ROAD NAMES	17/01/18
1	AMEND ALLOT 2041 & REMOVE	11/01/18
0	ISSUED TO CLIENT	14/12/17

**FYFE Earth Partners**  
 ACN 008 116 130  
 LEVEL 3, 80 FLINDERS STREET, ADELAIDE, SA, 5000  
 GPO BOX 2450 ADELAIDE SA 5001  
 TEL (08) 8201 9600 FAX (08) 8201 9650  
 E-mail info @ fyfe.com.au

REVISION : 5 DRAWING : 21003B17-R5  
 FILE No : 21003/21/4 DATE OF ISSUE : 26/09/2018  
 DRAWN : KAJ CHECKED : JJB

**BLEFARI**  
**MOUNT BARKER**  
 Stage 2B  
 Building Envelope Plan  
 Plan B  
 Scale 1:500

**NOTE:**  
 SUBJECT TO CONFIRMATION OF EASEMENTS.  
 Road layout and associated infrastructure is indicative only.  
 Road naming to be confirmed and subject to council approval.  
 Building on the boundary subject to council consent.

- LEGEND:**
- ☐ Stormwater Junction Box
  - Stormwater Grated Pit
  - ☐ Electrical Transformer Easement/Unit
  - ☐ Tree Pit
  - ⊙ Sewer IP
  - \* Light Pole

**BLEFARI**  
**MOUNT BARKER**  
**Stage 2A**  
**Building Envelope Plan**  
**Plan A**  
 Scale 1:500



**NOTE:**  
 SUBJECT TO CONFIRMATION OF EASEMENTS.  
 Road layout and associated infrastructure is indicative only.  
 Road naming to be confirmed and subject to council approval.  
 Building on the boundary subject to council consent.

REVISION	DATE	
5	EASEMENT IN 2039 REMOVED	26/09/18
4	UPDATE ROAD NAMES	29/06/18
3	UPDATE LOT 2036	09/02/18
2	UPDATE ROAD NAMES	17/01/18
1	AMEND ALLOT 2041 & REMOVE	11/01/18
0	ISSUED TO CLIENT	14/12/17

**FYFE Earth Partners**  
 ACN 008 116 130  
 LEVEL 3, 80 FLINDERS STREET, ADELAIDE, SA, 5000  
 GPO BOX 2450 ADELAIDE SA 5001  
 TEL (08) 8201 9600 FAX (08) 8201 9650  
 E-mail info@fyfe.com.au

REVISION : 5      DRAWING : 21003B17-R5  
 FILE No : 21003/214      DATE OF ISSUE : 26/09/2018  
 DRAWN : KAJ      CHECKED : JJB

- LEGEND:**
- ☒ Stormwater Junction Box
  - Stormwater Grated Pit
  - ☒ Tree Pit
  - ⊙ Sewer IP
  - \* Light Pole

Vide Right for Continuation

Vide Above Left



Future Stage

Future Stage